

Page - 78

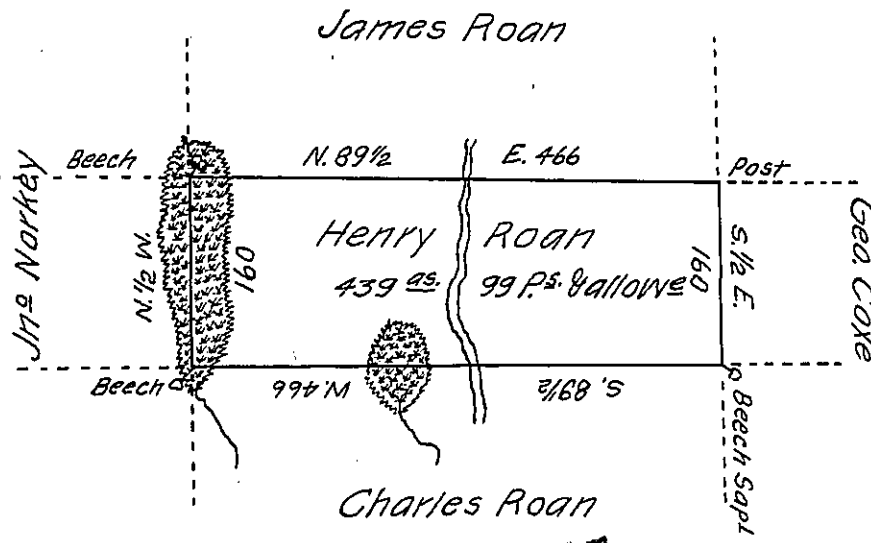

Page 77

A Draught of a tract of land called—— Situate in the County
of Luzerne, adjoining Charles Roan & others, surveyed the 29th day of
Oct^r 1792 for Henry Roan in pursuance of a warrant bearing date
the 3^d day of April 1792 containing Four hundred thirty-nine Acres &
ninety-nine perches & the allowance of Six & Cent.

To

Ant^y Crothers, D. S.

Dan^l Brodhead, Esq^r

Surveyor General

IN TESTIMONY that the above is a copy of the original remaining on file in
the Department of Internal Affairs of Pennsylvania, made
comformably to an Act of Assembly approved the 16th day of
February 1833, I have hereunto set my hand and caused
the Seal of said Department to be affixed at Harrisburg,
this eighteenth day of July 1907.

Henry Hoover
Secretary of Internal Affairs.